

The Hopwood Centre is located in Building D

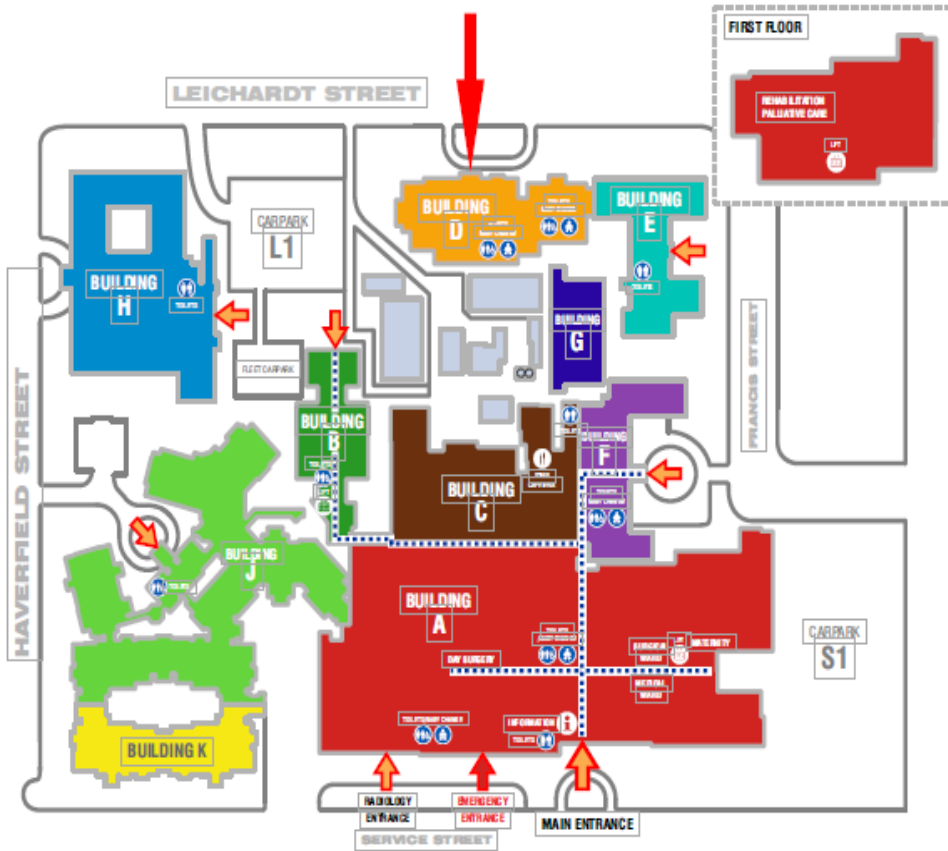

# COMMUNITY REHABILITATION PROGRAM

## Specialist Continence Clinic

Monday – Friday  
8:30am – 4:30pm

**The Hopwood Centre**  
Leichardt Street

Phone: 03 5485 5801  
Fax: 03 5485 5833



## **What is the Specialist Continence Clinic?**

- A clinic for men, women and children of all ages who are under the care of specialist medical services;
- This clinic offers help for people with bladder, bowel and pelvic floor muscle problems;
- Consultant physiotherapy and nursing services are available for assessment and treatment options.

## **How do I access this service?**

- You will need a referral from a General Practitioner (GP), Specialist Service, internal or external hospital or other health/allied health service;
- Upon receiving your referral, the team will be in contact with you.

## **What to expect?**

- Individual assessment and treatment plans;
- Advice on continence products and assistance with obtaining funding for products;
- Diagnostic tests;
- Access to additional allied health professionals as required for example Dietetics;
- Referral onto and liaising with specialists.